

HCFU2(Normal-duty)

Flange Units (Square)

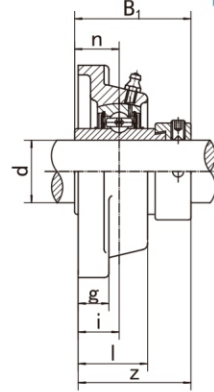
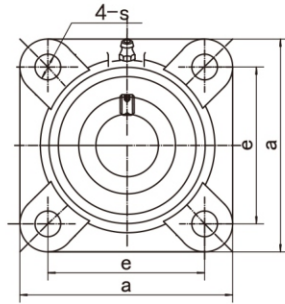

Unit NO.	Dimensions (mm / in.)										Bolt Size mm/in.	Bearing No.	Housing No.	Weight (kg)
	d	a	e	i	g	l	s	z	B ₁	n				
HCFU203 203-11	17 11/16	86 3-3/8	63.5 2-1/2	19 3/4	15 19/32	29.5 1-5/32	12 15/32	45.6 1-51/64	43.7 1.720	17.1 0.673	M10 3/8	HC203 HC203-11	FU203	0.70 0.70
HCFU204 204-12	20 3/4	86 3-3/8	63.5 2-1/2	19 3/4	15 19/32	29.5 1-5/32	12 15/32	45.6 1-51/64	43.7 1.720	17.1 0.673	M10 3/8	HC204 HC204-12	FU204	0.68 0.68
HCFU205 205-13 205-14 205-15 205-16	25 13/16 7/8 15/16 1	93 3-21/32	70 2-3/4	19 3/4	15 19/32	30 1-3/16	12 15/32	45.9 1-13/16	44.4 1.748	17.5 0.689	M10 3/8	HC05 HC205-13 HC205-14 HC205-15 HC205-16	FU205	0.79 0.84 0.83 0.81 0.79
HCFU206 206-17 206-18 206-19 206-20	30 1-1/16 1-1/8 1-3/16 1-1/4	106 4-11/64	82.5 3-1/4	20 25/32	16 5/8	32.5 1-9/32	12 15/32	50.1 1-31/32	48.4 1.906	18.3 0.720	M10 3/8	HC206 HC206-17 HC206-18 HC206-19 HC206-20	FU206	1.11 1.16 1.13 1.11 1.08
HCFU207 207-20 207-21 207-22 207-23	35 1-1/4 1-5/16 1-3/8 1-7/16	116 4-9/16	92 3-5/8	21 53/64	17 43/64	35 1-3/8	14 35/64	53.3 2-3/32	51.1 2.012	18.8 0.740	M12 7/16	HC207 HC207-20 HC207-21 HC207-22 HC207-23	FU207	1.47 1.54 1.50 1.47 1.45
HCFU208 208-24 208-25	40 1-1/2 1-9/16	129 5-5/64	101.5 4	24 15/16	17 43/64	39 1-17/32	14 35/64	58.9 2-5/16	56.3 2.217	21.4 0.843	M12 7/16	HC208 HC208-24 HC208-25	FU208	1.91 1.96 1.92
HCFU209 209-26 209-27 209-28	45 1-5/8 1-11/16 1-3/4	135 5-5/16	105 4-9/64	24 15/16	18 23/32	40 1-37/64	16 5/8	58.9 2-5/16	56.3 2.217	21.4 0.843	M14 1/2	HC209 HC209-26 HC209-27 HC209-28	FU209	2.11 2.22 2.17 2.13
HCFU210 210-29 210-30 210-31 210-32	50 1-13/16 1-7/8 1-15/16 2	143 5-5/8	111 4-3/8	28 1-3/32	20 25/32	45 1-49/64	18 23/32	66.1 2-39/64	62.7 2.469	24.6 0.969	M16 5/8	HC210 HC210-29 HC210-30 HC210-31 HC210-32	FU210	2.60 2.75 2.69 2.63 2.57
HCFU211 211-32 211-33 211-34 211-35	55 2 2-1/16 2-1/8 2-3/16	162 6-3/8	130 5-1/8	31 1-7/32	21 53/64	49 1-59/64	18 23/32	74.6 2-15/16	71.4 2.811	27.8 1.094	M16 5/8	HC211 HC211-32 HC211-33 HC211-34 HC211-35	FU211	3.56 3.86 3.68 3.61 3.53
HCFU212 212-36 212-37 212-38 212-39	60 2-1/4 2-5/16 2-3/8 2-7/16	175 6-57/64	143 5-5/8	34 1-11/32	22 55/64	53.5 1-7/64	18 23/32	80.8 3-3/16	77.8 3.063	31 1.220	M16 5/8	HC212 HC212-36 HC212-37 HC212-38 HC212-39	FU212	4.46 4.48 4.53 4.47 4.45
HCFU213 213-40 213-41	65 2-1/2 2-9/16	184 7-1/4	149 5-55/64	38 1-1/2	22 55/64	58 2-9/32	18 23/32	89.6 3-17/32	85.7 3.374	34.1 1.343	M16 5/8	HC213 HC213-40 HC213-41	FU213	5.51 5.62 5.50
HCFU214 214-42 214-43 214-44	70 2-5/8 2-11/16 2-3/4	188 7-13/32	152 5-63/64	38 1-1/2	23 29/32	59 2-21/64	18 23/32	89.6 3-17/32	85.7 3.374	34.1 1.343	M16 5/8	HC214 HC214-42 HC214-43 HC214-44	FU214	5.86 5.80 5.99 5.87
HCFU215 215-45 215-46 215-47 215-48	75 2-13/16 2-7/8 2-15/16 3	200 7-7/8	159 6-17/64	41 1-39/64	24 15/16	62 2-7/16	18 23/32	95.8 3-49/64	92.1 3.626	37.3 1.469	M16 5/8	HC215 HC215-45 HC215-46 HC215-47 HC215-48	FU215	6.77 7.07 6.94 6.81 6.67